



DATA SHEET

K-WALL INTERLOCKING CONCEALED FASTENER PANEL

OVERVIEW

An industry staple, this 1-1/2" deep by 12" wide panel provides Owners and Architects with an economical flush faced wall and soffit assembly. It can be installed horizontally or vertically.

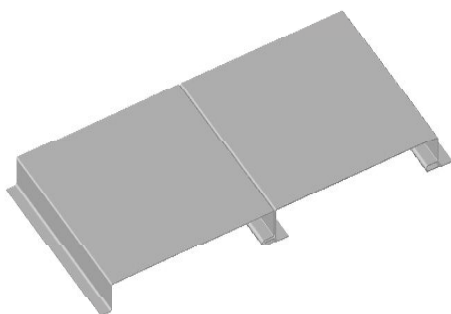

SYSTEMS DESCRIPTION

Wide variety of materials and finish options available:
available:

- Depths of 1" or 1-1/2"
- Lengths up to 20'-0"
- Reveals of 1/2", 1", 2" or 6"
- Stiffening ribs
- Embossing
- Factory end tabs

Perforating is also available for screening or venting applications.

Standard Material Options

- Steel/Galvalume
24ga, 22ga, 20ga, 18ga
- Aluminum
.040", .050", .063"

Contact Kovach for thicker material options and the availability of stainless steel, copper and zinc applications. A wide selection of standard, metallic/exotic, custom and wood grain colors, using Kynar® 500 paint systems.

"Oil canning" may be evident in the broad flat portion of the panel. Every effort is made to eliminate oil canning through gauge/material selection, proper thermal consideration, and embossing or adding stiffener ribs. The structural integrity of the panel systems are in no way affected by this phenomenon and therefore any appearance of the effect is not cause for material rejection.

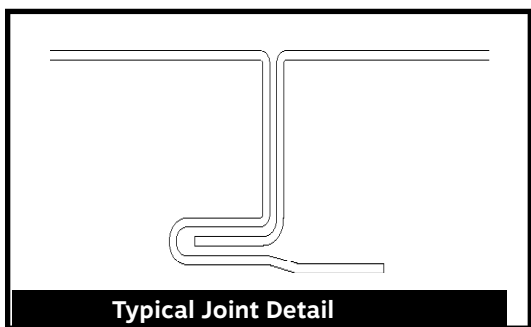

Typical Joint Detail

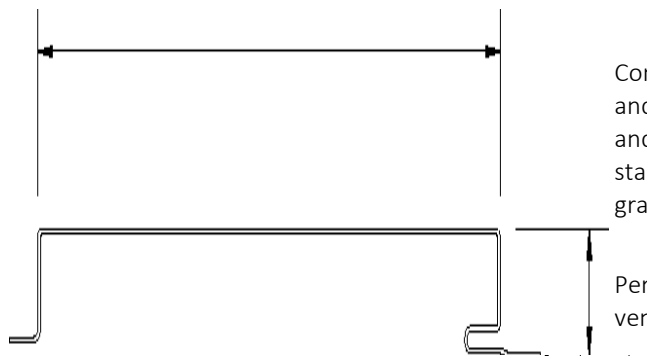

Perforating is also available for screening or venting applications.